

Drives for Bowl Feeders

Characteristics

- Available in diameters from 100 mm to 750 mm
- Head plate individually adjustable
- Smooth running, therefore particularly gentle on parts
- High conveying capacity
- Easy to remove drive protection
- Safe transport, even of very light or very heavy parts
- Also for parts with complex geometry, e.g. springs or tangled parts
- Suitable for many materials, even those with high friction: plastic, metal, rubber ...
- Energy-efficient: less energy input with high conveying capacity
- Very good price-performance ratio

Technical data

SFE 100 -
SFE 650

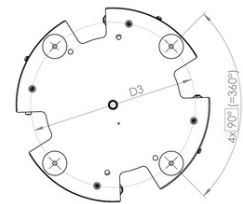
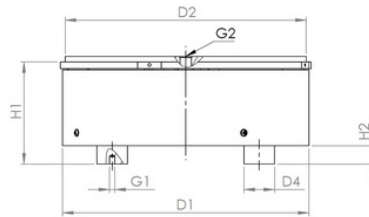

NEW
SFE 750

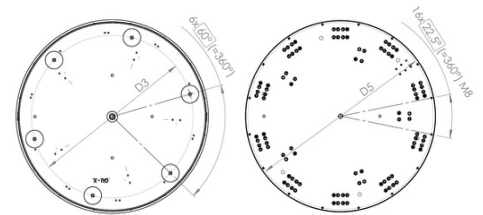
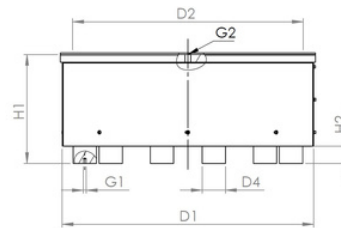

	Measure (unit)	SFE 100	SFE 150	SFE 200	SFE 280	SFE 400	SFE 500	SFE 650	SFE 750
Drive Diameter	ØD1 in mm	100	150	200	280	400	500	650	800
Attachment Diameter	ØD2 in mm	107	162	195	276	394	495	643	750
Pitch circle	ØD3 in mm	78	120	166	230	340	430	560	690
Foot diameter	ØD4 in mm	15	25	25	30	50	50	75	75
Pitch circle adapter ring	ØD5 in mm	-	-	-	-	-	-	-	800
Drive height	H1 in mm	82,5	114	117	132	167	204	247	349
Foot height	H2 in mm	15	20	20	30	30	30	55	55
Foot thread	G1	M4	M6	M6	M8	M10	M10	M12	M12
Central attachment	G2	M6	M8	M8	M12	M16	M16	M16	M16
Apparent power	VA	19	100	200	500	800	1.600	1.600	2.250
Weight	kg	2	5	12	25	50	100	180	400